

North 1/4 Corner
Section 28-2-16.
N. 225.921.05
E. 2,374.287.09

S0°59'43"E 963.00'
(S0°44'W 963.12')

West line of the Northeast 1/4 of Section 28-2-16.
S0°59'43"E 1784.88'
(S0°59'43"E 1784.93') State Plane

Witness Corner
Section 28-2-16.
N. 224.136.42
E. 2,374.318.09

Lands described on Quit Claim
Deeds recorded August 10, 1994,
as shown below:

John P. Dunphy & Pamela L.
McEachern to the Town of Delavan,
Recorded in Vol. 631, on Page
4813, as Document No. 290756.

Eduardo R. Bernudez to the
Town of Delavan, Recorded in
Vol. 631, on Page 4814, as
Document No. 290757.

Dwight Arneson & Margaret
Arneson to the Town of Delavan,
Recorded in Vol. 631, on Page
4815, as Document No. 290758.

Rodney Negley & Shirley
Negley to the Town of Delavan,
Recorded in Vol. 631, on Page
4816, as Document No. 290759.

Lake View Avenue

Unimproved

(35' Wide)

St. Kathryn Street

(10' Wide)

"Beckman Drive"

(10' Wide)

"Public Walk"

(4' Wide)

"Fleming Drive"

(50' Wide)

Tax Parcel
F D 2800002A

Tax Parcel
FFA 00001B

Tax Parcel
FFA 00001

Lot 1
C.S.M. 4044
Tax Parcel
FA404400001

Garage
No. 2208

Tax Parcel
FC 00010A

Garage
No. 2210

House
No. 2201

House
No. 2207
Tax Parcel
FFA 00003

Tax Parcel
FFA 00011

Tax Parcel
FFA 00004

Tax Parcel
FFA 00005

Tax Parcel
FMAS 00002

Tax Parcel
FMAS 00003

Plat of Survey

of

The location of "Fleming Drive",

over Lots 2 and 41 of The Fleming Addition, located in
Government Lot 1 in the Northeast 1/4 of Section 28,
Town 2 North, Range 16 East, Town of Delavan,
Walworth County, Wisconsin.

Surveyed for: **Town of Delavan**

5621 Town Hall Road
Delavan, Wisconsin. 53115

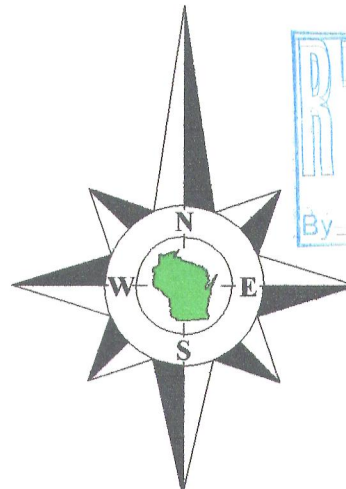

Bearings reference to the Wisconsin State
Plane Coordinate System, South Zone.

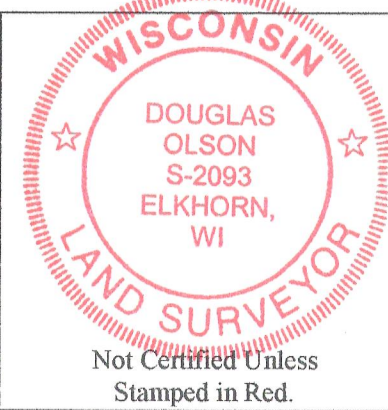

Notes:

- 1) This survey plat is not certified unless signed and sealed in red ink.
- 2) This survey is subject to Wisconsin lien laws. This Plat of Survey is the notice of intent to file lien. Lien waiver required.

Copyright 2011 by Jensen & Olson Land Surveying, LLC.

All rights reserved. No part of this survey plat may be reproduced or transmitted in any form by any means - graphic, electronic, or mechanical, including photocopying, tracing, or information storage and retrieval systems - without permission in writing from Douglas G. Olson, Jensen & Olson Land Surveying, LLC.

I, Douglas G. Olson, Wisconsin Registered Land Surveyor, do hereby certify that this survey was performed by me, or under my direction in full compliance with the owner's/agent's instructions and Chapter A-E 7 of the Wisconsin Administrative Code "Minimum Standards for Property Surveys"; and that this map is an accurate representation thereof to the best of my knowledge and belief.

Douglas G. Olson
Wisconsin Registered Land Surveyor - 2093

Survey Date: May 19, 2011.
Revisions: No. 1 - Quit Claim Deeds

Scale in Feet
1" = 20'



Jensen & Olson Land Surveying, LLC
45 South Wisconsin Street * P.O. Box 322 * Elkhorn, Wisconsin. 53121
Telephone: (262) 723-3434 * Facsimile: (262) 723-8044
Email: jensen.olson@elknet.net

Legend
Found County Section Corner
Found Iron Pipe
Found Iron Rod
Found Spindle
Found Set Iron Rod
Found Set Mag Nail
Recorded Information
Utility Pole
Manhole Surface
Concrete Surface
Gravel Surface

Sheet 1 of 1 Sheets

Job Reference Number

2010.122

2010.122

FFA-12 FFA-11 FFA-5 FFA-4 FFA-3 FFA-2

216-4914